

versatile™ 4C Surface Mount Collar, SM15S

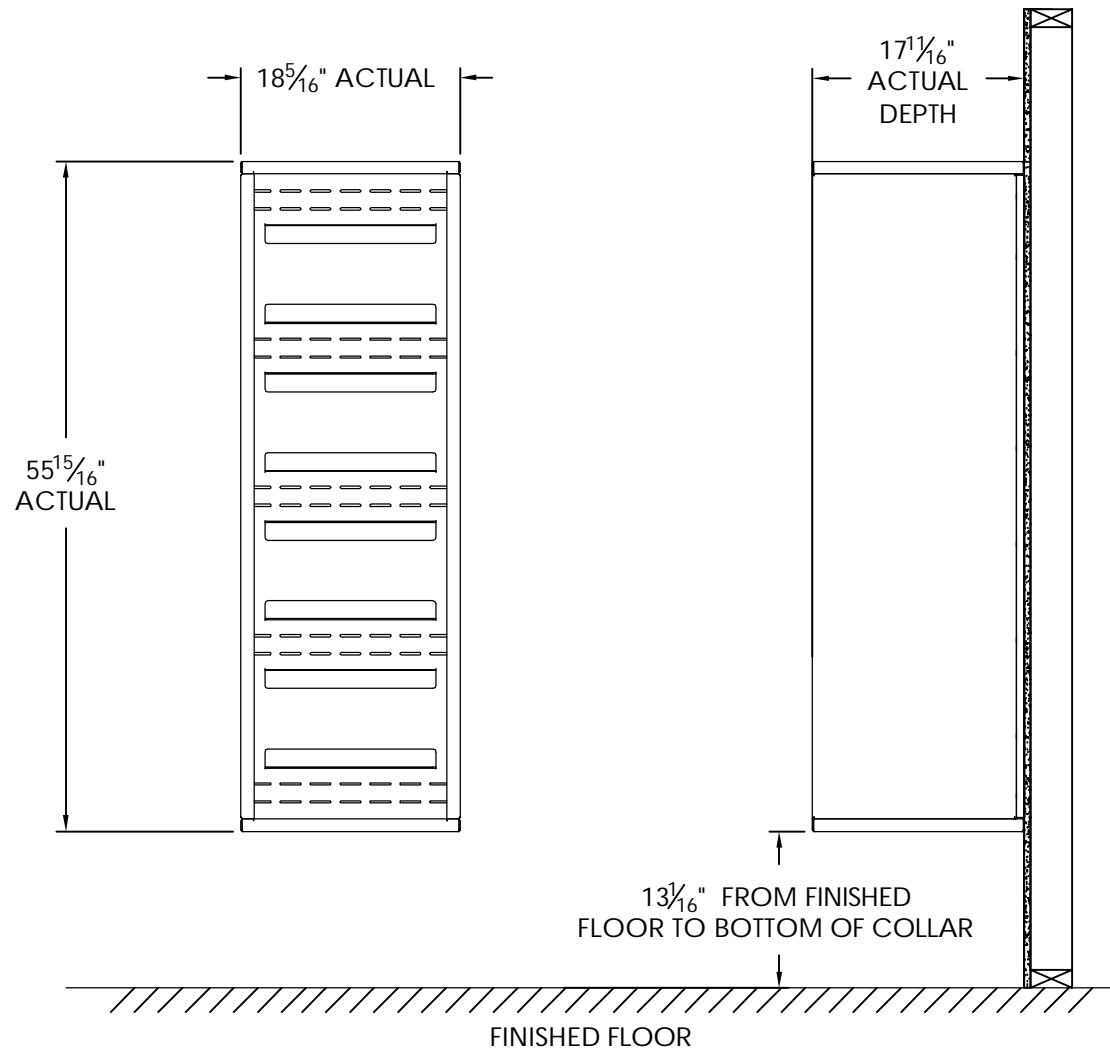

Notes:

1. Designed to mount Florence Versatile™ 4C mailbox single column 15-High Suite modules (sold separately).
2. For use with front loading modules only.

PRODUCT SERIES: VERSATILE™ 4C SURFACE MOUNT COLLAR

AF FLORENCE
manufacturing company

5935 Corporate Drive • Manhattan, KS 66503
www.florencemailboxes.com • (800) 275-1747

A GIBALTAR INDUSTRIES COMPANY

MODEL	SM15S	REV	B
SCALE	NONE	LAST REV DATE	7/02/2014
DRAWING NUMBER	SM15SCS	DRAWN BY	TNS

versatile™ 4C Mailbox, 4C15S-13

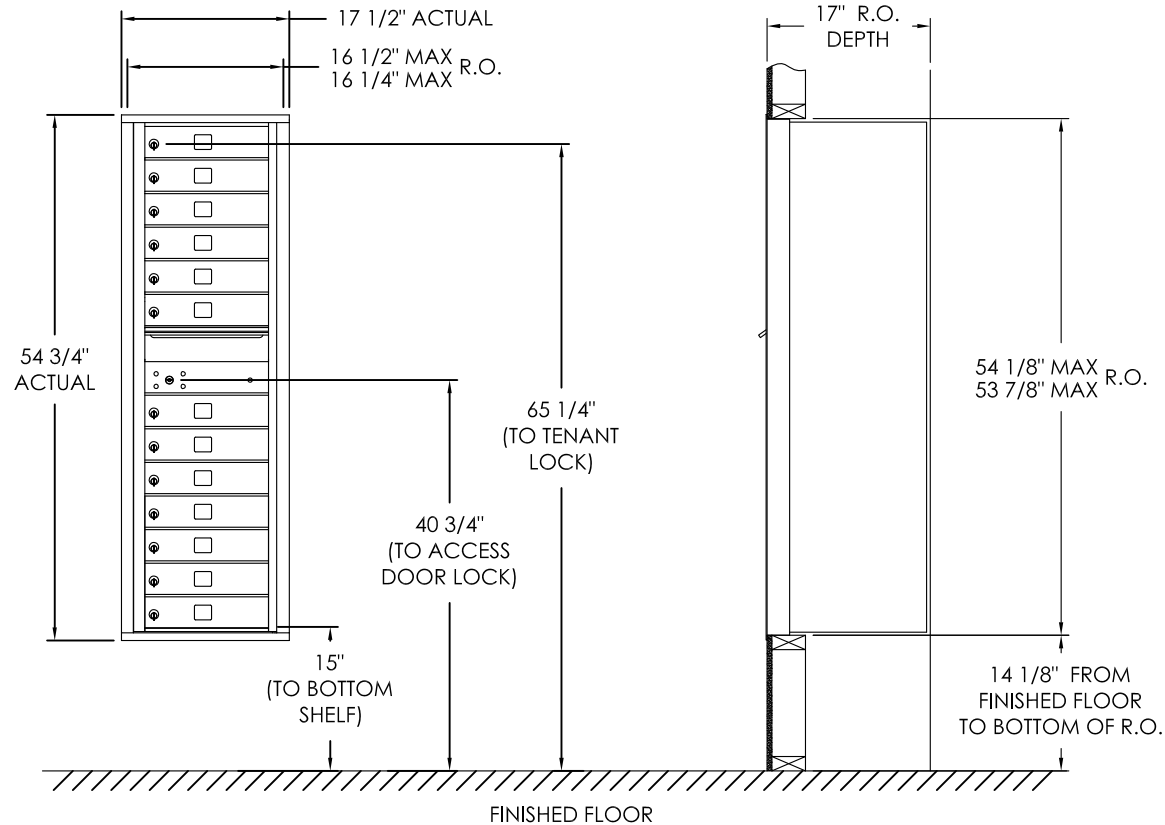

COMPARTMENT CHART

DESCRIPTION	COMPARTMENT	COMPARTMENT SIZE	QTY.
MAILBOX	MB1	3" H x 12" W x 15" D	13
OUTGOING MAIL	OM2	6-1/2" H x 12" W x 15" D	1

Notes:

1. This module does NOT meet USPS STD-4C installation specification requirements because there are customer compartments (interior bottom shelf) positioned less than 28" AFF
2. This 4C mailbox can be used for private applications.
3. The rough opening width for multi-unit 4C installations is provided using the Florence configurator: www.florencemailboxes.com/configurator.

PRODUCT SERIES: VERSATILE™ 4C FRONT LOAD MAILBOX

FLORENCE
CORPORATION

5935 Corporate Drive • Manhattan, KS 66503
800.275.1747 • www.florencemailboxes.com

MODEL 4C15S-13	REV F
SCALE NONE	LAST REV DATE 07/08/19
DRAWING NUMBER 4C15S-13CS	DRAWN BY RAK